

ASSEMBLY - GT4RB

1. Install the Trim brackets Left and Right & Rear

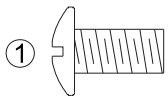

Phillips Head Screw
1/4"x3/8"
Qty.4

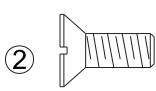

Countersunk Flat Head Screw
1/4"x3/8"
Qty.6



Flange Nut 1/4"
Qty.6

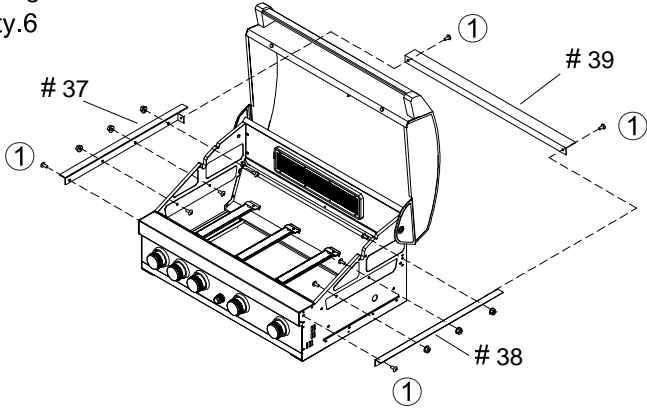

2. Regulator and Install the grill onto the housing .

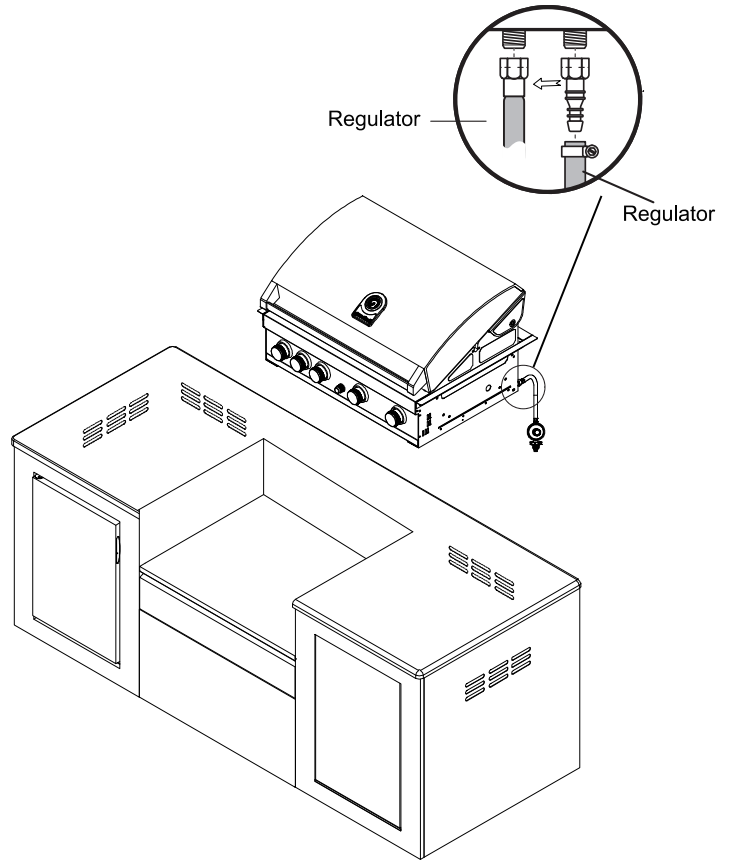

3. Install Grease Tray

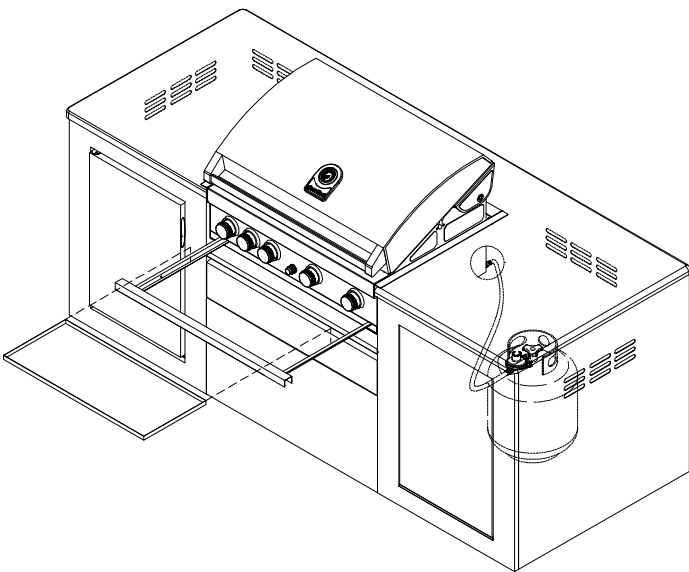

MOUNTING CUT - OUT

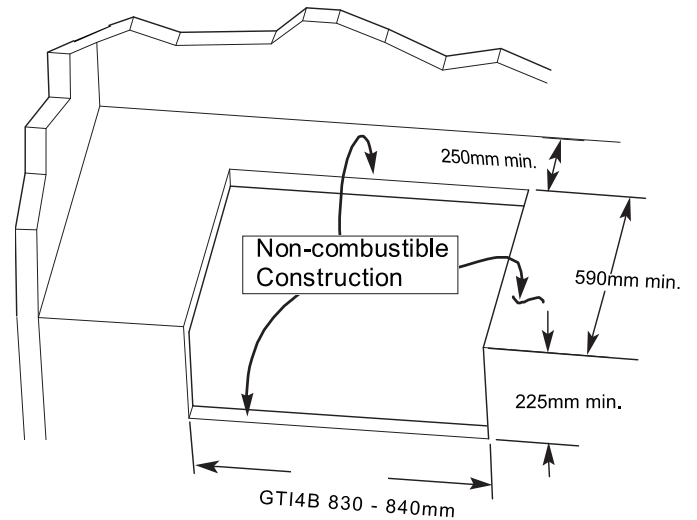

Note:the above illustration is for example only.